

Viewings

Viewings by arrangement only.
Call 0114 483 0038 to make an appointment.

Vendors Comments

Add text here

Energy Efficiency Rating		
	Current	Potential
Very energy efficient - lower running costs		
(92 plus) A		
(81-91) B		
(69-80) C		
(55-68) D		
(39-54) E		
(21-38) F		
(1-20) G		
Not energy efficient - higher running costs		
England & Wales		
	EU Directive 2002/91/EC	

JC SALES & LETTINGS

Tel: 0114 483 0038

E-mail: sales@jc-salesandlettings.com

Website: www.jc-salesandlettings.com



Room 2 33 Norfolk Street, Stoke-On-Trent, ST1 4PB

£400 Per month

- Available for immediate occupation
- Very well presented
- Shared house
- Close to an abundance of local amenities
- EPC Grade E
- All bills included in the rental payments
- Double bedroom with en-suite
- Excellent location
- Viewing highly recommended

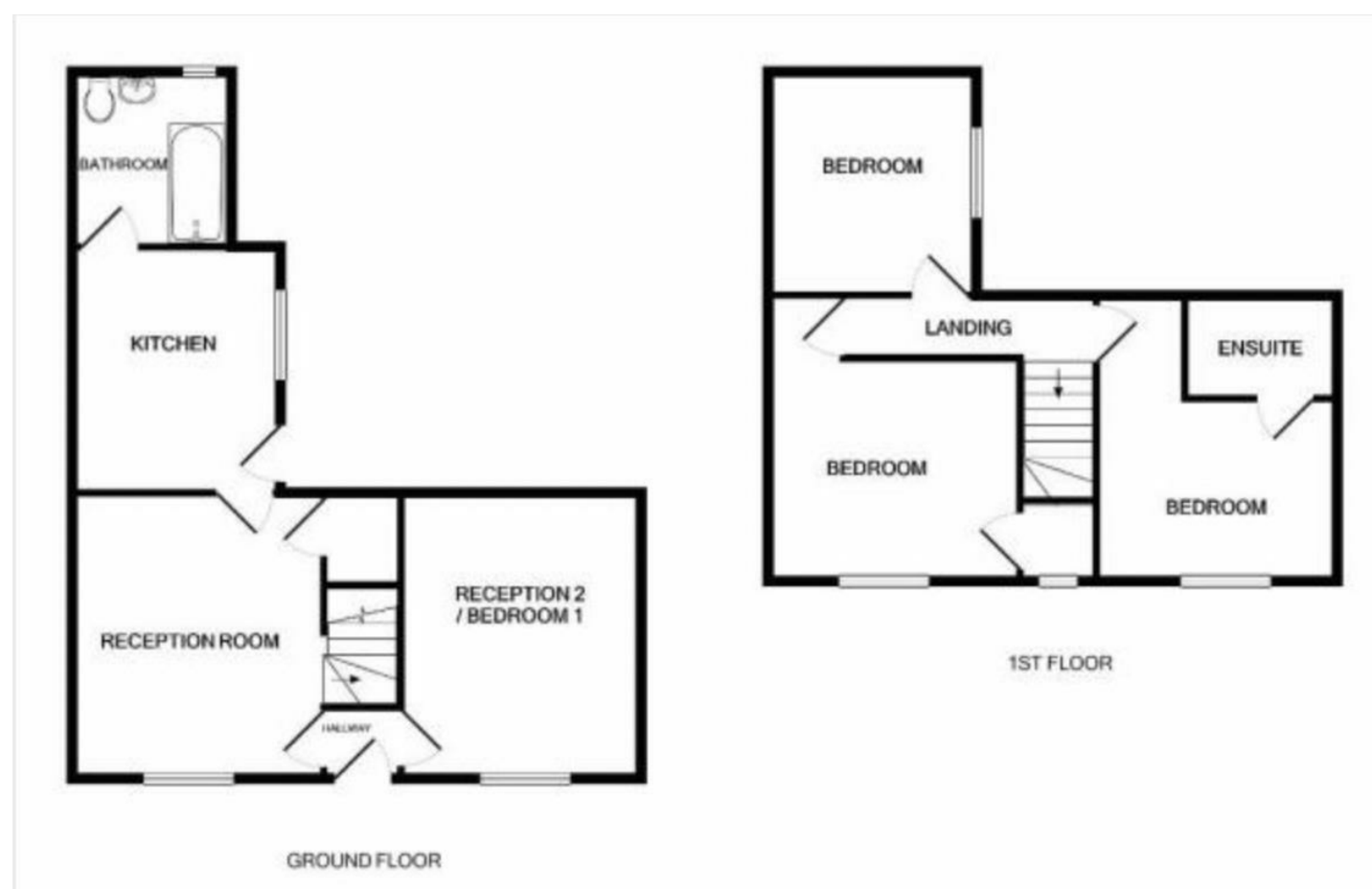

Room 2 33 Norfolk Street, Stoke-On-Trent ST1 4PB

AVAILABLE FOR IMMEDIATE OCCUPATION

EN-SUITE DOUBLE BEDROOM WITH ALL BILLS INCLUDED IN THE RENT

Available immediately, is this very well presented, en-suite double bedroom in a shared house.

Situated in the highly sought after location of ST1, close to an abundance of local amenities and public transport links.

An early viewing is highly recommended to avoid disappointment!

EPC Grade E.



Council Tax Band: A

